

Marine Transmissions

PRM 80

Workshop Manual

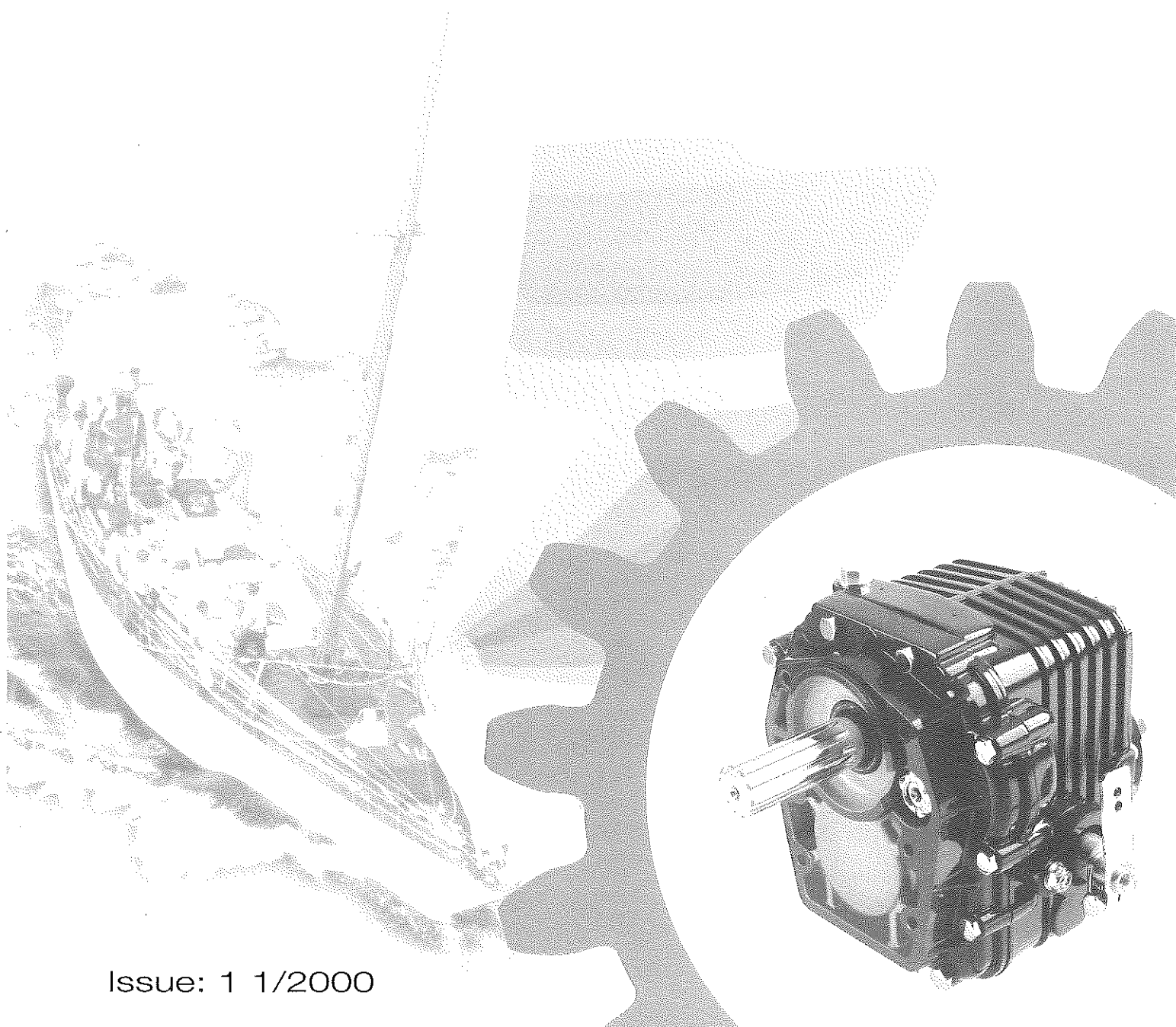

Issue: 1 1/2000



The following international symbols are used in this service manual.



WARNING: THIS SYMBOL WARNS OF POSSIBLE PERSONAL INJURY



CAUTION: THIS SYMBOL WARNS OF POSSIBLE DAMAGE TO TRANSMISSION

Newage Transmissions operate a policy of product improvement and therefore reserve the right to change specifications without prior notification. Whilst every effort is made to ensure complete accuracy of the information in this manual no liabilities for inaccuracies or the consequences thereof can be accepted by the manufacturer or the distributor/dealer who supplied the manual.

CONTENTS

SECTION		PAGE
	List of illustrations	3
	Foreword	4
	Warranty information	4
	Pre-delivery test	4
	Identification plate information	5
1	GENERAL DATA	6
	1.1 Specifications	6
2	INTRODUCTION	7
3	CONSTRUCTION	7
4	OPERATION	7
	4.2 Lubrication	7
	4.3 Type of oil	7
5	INSTALLATION	8
	5.1 General	8
	5.2 Checking the engine flywheel housing	8
	5.3 Checking the engine flywheel	8
	Installation drawing	9
	5.4 Mounting the gearbox to the engine	10
	5.5 Alignment to propeller shaft	10
	5.6 Installation angle	10
	5.7 Remote control operating systems	11
6	OPERATION	11
	6.1 First time usage	11
	6.2 Drive selection	11
	6.3 Trailing (freewheeling) the propeller	11
7	ROUTINE MAINTENANCE	11
	7.1 Initial maintenance (after 25 hours running)	11
	7.2 Daily checks	11
	7.3 Six monthly check	11
	7.4 Annual check	11
8	FAULT FINDING	12
9	SERVICING AND REPAIRS - GENERAL	13
	9.6 Disassembly of gearbox	13
	9.7 Re-assembly of gearbox	14
	9.7.5 Shimming the bearings	15
	9.7.6 Selector mechanism shimming	16
10	SPECIAL TOOLS	16
	10.2 Tightening torques	16
11	REPLACEMENT ORDERING PARTS	16
	Replacement parts list and assembly drawings	17

LIST OF ILLUSTRATIONS

	Page
Fig 1 PRM80 General View	3
Fig 2 Checking runout of flywheel and flywheel housing	8
Fig 3 Installation drawing	9
Fig 4 Setting bearing pre-load	15



Fig. 1

FOREWORD

Provided it is correctly installed, aligned and maintained, the PRM80 gearbox should have a long and trouble-free life. This workshop manual contains important instructions to ensure that this is so, and it is of the utmost importance that these are carefully followed. Newage Transmissions Ltd. can accept no responsibility under warranty or otherwise for any loss or damage resulting from failure to observe these instructions.

To avoid prejudicing your rights under warranty, do not undertake any repair or other work on the gearbox during the warranty period without first contacting Newage Transmissions Ltd. or an authorised distributor/dealer for advice. In the event of failure, you should do this via the engine distributor who supplied the gearbox, or his local dealer; if this is not possible, you should notify the local Newage distributor/dealer or Newage Transmissions Ltd. direct, quoting the serial number.

CLAIMS UNDER WARRANTY

Claims for replacement of parts under warranty must always be submitted with the gearbox serial number to the distributor who supplied the gearbox; if this is not possible, application may be made to the nearest distributor, who must, however, be advised of the supplier's name and address.

SERVICE PARTS

The comprehensive illustrated parts list gives full information and ordering procedure.

PRE-DELIVERY TEST

Before it leaves the factory, every gearbox is subjected to a final test and inspection which includes the following:-

1. Flush clean.
2. Pressurise the case, and check for leaks.
3. Check drag torque in ahead, neutral and astern.
4. Run gearbox in neutral, ahead and astern.
5. Check force to engage and disengage ahead and astern gear.
6. Check noise levels.
7. Check output nut torque.
8. Check coupling concentricity.

IDENTIFICATION PLATE

Every PRM gearbox is fitted with an identification plate on the top of the gearcase before it leaves the factory; an example of such a plate is shown below.

NEWAGE	PRM	COVENTRY
123456		R1234
80D2.5		
MADE IN ENGLAND		

NEWAGE	PRM	COVENTRY
MADE IN ENGLAND		

Please complete the above box with serial number and specification of your own gearbox.

It will be noted that there are two lines of numbers.

The top line is the gearbox serial number, and should always be quoted when ordering spare parts; the lower line is the gearbox specification, in the example given this translates as follows:-

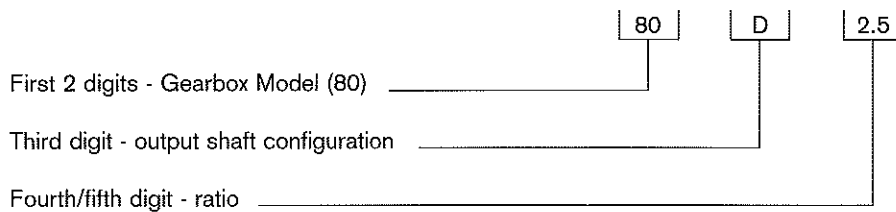

NOTE: Throughout this manual, engine, gearbox and propeller rotation are always described as seen looking forward from the propeller to the engine.

SERVICE CLASSIFICATION DEFINITIONS

PLEASURE Limited to craft used exclusively for pleasure boating; operation at full engine throttle should not exceed 5% of total time, with balance of usage at 90% of full throttle engine speed, or less. Maximum operation 500 hours per year. The selection of PRM80 according to this classification for any commercial boat is not approved by Newage Transmissions Limited.

LIGHT COMMERCIAL Newage Transmissions Limited recommends that when considering the use of the PRM80 in boats of whatever hull form used in light commercial applications, and in displacement and semi-displacement hull boats for pleasure applications, these boats should be classed as light commercial duty and the gearbox selected accordingly. Maximum operation - 2000 hours per year.

IMPORTANT NOTE: (1) It is essential for the engine, transmission model, reduction ratio and propeller size to be correctly matched so that the engine can attain its rated speed appropriate to the relevant service classification without labouring.

1. GENERAL DATA

1.1 Specifications

Gear ratios - ahead

2.000:1, 2.474:1

Gear ratio - astern

2:474:1- common

POWER RATING

AHEAD RATIO	PLEASURE		LIGHT COMMERCIAL	
	BHP	kW	BHP	kW
2.000:1	1.12	0.84	0.74	0.55
2.474:1	0.98	0.73	0.65	0.48
Max. Input Power	47	35	32	24

Note: These powers are expressed in BHP and kW per 100 rev/min engine speed, and are measured at the engine flywheel. Ratings have been established to ensure the long trouble-free life of the gearbox which should not, therefore be used at powers in excess of those shown.

Input speed:

Maximum operating speed 5000 rev/min.

Input rotation:

For engines of left-hand (anti-clockwise) rotation as viewed looking on the flywheel from behind the engine.

Output rotation:

Right-hand (clockwise) in ahead direction. **IMPORTANT: RIGHT HAND PROPELLER REQUIRED**

Approximate dry weight:

11.3kg (4.5lb) excluding adaptor flange.

Oil capacity:

0.57 litres (1 pint).

Working oil temperature:

The normal operating temperature should be in the range 50°C to 120°C.

Engine Mounting adaptors:

Available in SAE5 and Velvet Drive (Borg Warner).

Input drive couplings:

Flexible centre damper plate SAE 6.5" or SAE 7.5".

Gearcase:

Made from heavy duty aluminium alloy for use in a marine environment, webbed internally for strength and rigidity, external fins to aid cooling.

Input shaft:

28.5mm diameter with 10 tooth spline to DIN5464.

Propeller thrust:

Ahead and astern thrust is carried by output shaft bearings of ample capacity for the approved rating.

Output flange:

102mm diameter, with 4 holes 10.5mm diameter on 82.5 pitch circle diameter.

Installation angle:

The maximum fore and aft installation angle at rest is 15°.

2. INTRODUCTION

Newage Transmissions Ltd. PRM80 marine transmission is a simple, lightweight, mechanically operated gearbox for use in pleasure craft. Ahead and astern is selected by engaging a cone clutch which requires no adjustment. The PRM80 can only be installed onto engines that rotate left hand (anti-clockwise) as viewed when standing behind the gearbox output coupling facing towards the engine flywheel.

3. CONSTRUCTION**3.1 Gearcase**

The gearcase is made from heavy duty aluminium alloy rigidly designed and externally ribbed for efficient heat dissipation. The case assembly comprises two halves vertically split to facilitate servicing.

3.2 Gear train

The gear train is manufactured from high grade steel with all gears being hardened for long life. All shafts are supported on ball bearings which are amply proportioned to absorb all the thrust from the propeller.

4. OPERATION**4.1 Output Rotations**

With the control lever in the mid, or neutral position no power is transmitted to the propeller as the cone clutch is not engaged with either ahead or astern gears. Moving the lever forward i.e. towards the engine selects ahead, and rearwards i.e. towards the propeller selects astern. In ahead the output shaft rotates in the opposite direction to the input shaft (which rotates as engine). **It is therefore necessary to fit a right hand propeller.**

4.2 Lubrication

All lubrication is supplied by internal splash with oil cooling being by radiation through the gearbox case.

4.3 Approved oils

AUTOMATIC TRANSMISSION FLUID (ATF)

5. INSTALLATION

5.1 General

Drive is transmitted from the engine to the gearbox via a flexible centre drive plate (damper plate) which bolts to the engine flywheel, the gearbox input shaft is driven from the centre spline.

These drive plates have a degree of torsional flexibility, the purpose being to reduce engine torsional or cyclic vibrations and prevent them being passed to the transmission.

The strongest engine vibrations are usually those caused by firing in the cylinders; diesel engines which have high compression ratios, usually generate stronger vibration pulses than petrol (gasoline) engines; and it is often the case that of two engines of roughly equivalent size, the one having the greater number of cylinders will tend to run more smoothly than the one with fewer cylinders, although this is by no means always the case.

In all marine installations, correct alignment of the engine, gearbox and propeller shaft is extremely important - misalignment can cause noise, vibration and premature failure - and it is strongly recommended that all the procedures detailed in this manual are carefully followed.



CAUTION: It is particularly important to ensure the torsional compatibility of the complete propulsion system from engine through to propeller since disregarding this may result in gear noise at low speed operation and in extreme cases damage or failure of components.

Newage Transmissions Ltd. will provide all possible information and assistance to help find solutions to potential torsional problems, but it is the ultimate responsibility of the person assembling the drive and driven equipment to ensure that they are torsionally compatible.

5.2 Checking the engine flywheel housing

Attach a dial test indicator, calibrated in units of 0.025mm (0.001in.) or smaller, to the flywheel so that the measuring stylus of the indicator is perpendicular to the bore of the flywheel housing (bore A on Fig.2). Rotate the flywheel and check the deviation on the indicator over one complete revolution: this should not exceed 0.152mm (0.006in.) total indicator reading.

With the dial test indicator still attached to the flywheel, re-position the stylus so that it is perpendicular to the face of the flywheel housing (face B on Fig. 2). Rotate the flywheel and check the deviation over one complete revolution; again, this should not exceed 0.152mm (0.006in.) total indicator reading.

5.3 Checking the engine flywheel

Attach a dial test indicator, calibrated to 0.025mm (0.001in.) or less, to the engine flywheel housing so that the measuring stylus of the indicator is perpendicular to the bore of the register in the flywheel (bore C on Fig. 2). Rotate the flywheel through one complete revolution and note the deviation, this should not exceed 0.125mm (0.005in.) total indicator reading.

With the dial test indicator still attached to the flywheel housing, reposition the stylus so that it is perpendicular to the face of the flywheel register (D on Fig. 2). Rotate the flywheel through one complete revolution and note the deviation, this should not exceed 0.125mm (0.005in.) total indicator reading.

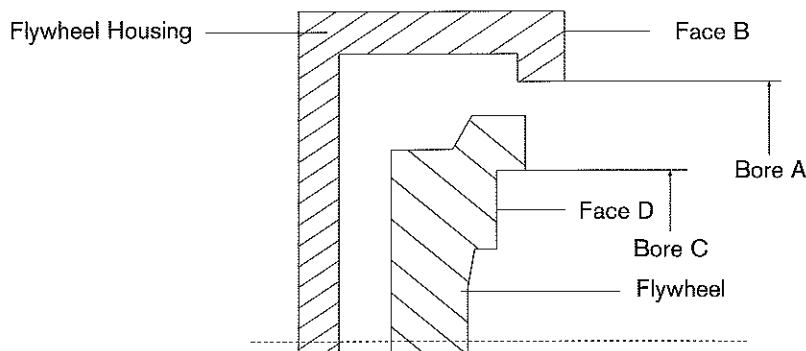
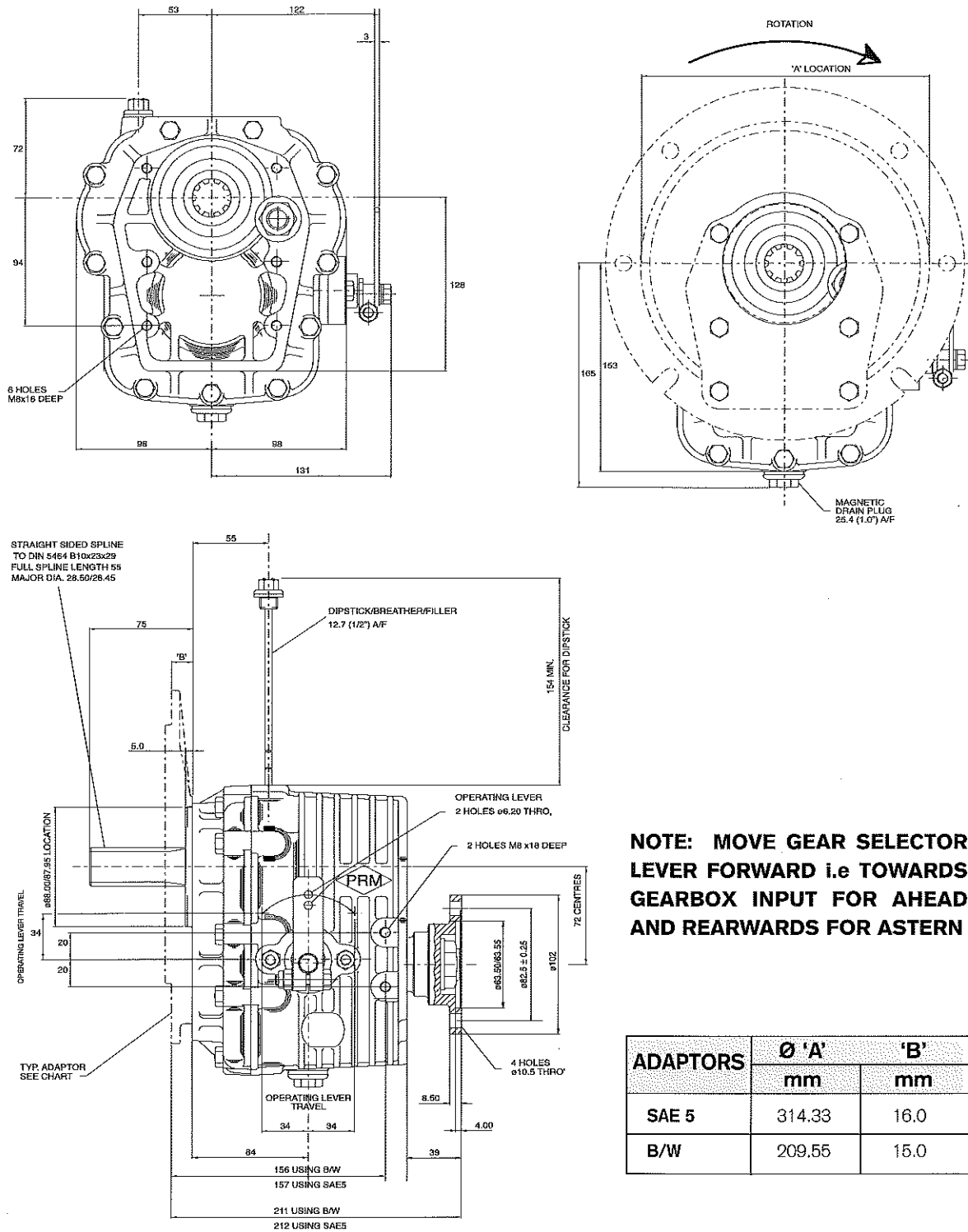

Fig. 2 Checking the flywheel and flywheel housing

BASIC INSTALLATION DETAILS - PRM80



NOTE: MOVE GEAR SELECTOR LEVER FORWARD i.e TOWARDS GEARBOX INPUT FOR AHEAD AND REARWARDS FOR ASTERN

ADAPTORS	Ø 'A'	'B'
	mm	mm
SAE 5	314.33	16.0
B/W	209.55	15.0

IMPORTANT NOTE

All information given in this manual is correct at the time of going to press. However, in the interests of technical progress, design specifications are subject to change without notice. Accordingly, data given herein should be regarded as a general guide only and does not form part of any contract. Any specific performance requirements must be made known to us in writing with customer orders for goods. Illustrations are approximate only and do not form part of any contract with us; certified installation drawings are available on request. All goods are supplied in accordance with our standard terms and conditions of sale.

INSTALLATION ANGLE
The maximum fore and aft installation angle permissible at rest is 15°.

Fig. 3

5.4 Mounting the gearbox to the engine

1. Mount the drive plate to the flywheel, using an alignment mandrel if available, and bolt to the flywheel. Where components to SAE standard are used, the outside diameter of the drive plate should be a close fit in the register on the flywheel.

If a mandrel is not available, tighten the bolts just sufficiently to prevent free movement, assemble the gearbox to the drive plate and rotate the engine two or three revolutions by hand to align the plate.

Tighten up two or three opposite bolts. Remove the gearbox and fully tighten all the drive plate bolts.

2. Offer the gearbox and adaptor up to the drive plate and flywheel housing. Insert the gearbox input shaft into the centre of the drive plate (it may be necessary to rock the shaft slightly to ensure the splines align). Press the assembly fully into position, align the holes in the adaptor with those on the flywheel housing and tighten fully. See fastening torque chart 10.2, page 16.

5.5 Alignment to propeller shaft



CAUTION: Alignment between the propeller shaft and the mating flange on the gearbox output shaft is extremely important since excessive vibration and stress may lead to premature failure if correct alignment is not achieved.

In the majority of boats whose hulls are rigid enough to prevent excessive flexing in heavy sea conditions, (which could cause the engine and transmission to shift relative to the propeller shaft), it is generally considered preferable to couple the propeller shaft direct to the gearbox output flange by means of a rigid coupling.

The two main conditions when a flexible coupling should be used are:

- a) in boats whose hulls are not sufficiently rigid to prevent the flexing referred to above,
- b) in cases where the engine is mounted on flexible mounts.

In both instances, the flexible coupling helps to isolate engine vibration or other movement from the propeller shaft thus enabling correct alignment with the propeller shaft and stern tube to be maintained.

Whether a solid or flexible coupling is used, it is extremely important that the following points are carefully checked:

- i) the coupling should be a tight press fit on the shaft and the keyway accurately made to the correct size, and
- ii) the two halves of the coupling should be carefully aligned. This should be done by bringing the two flanges close enough together so that a feeler gauge can be used to check the vertical and horizontal alignment.
- iii) alignment should only be carried out with the boat afloat. The maximum permissible misalignment being 0.05mm.

Since the propeller shaft line is normally fixed in the boat, alignment is usually obtained by adjusting engine mount shims on the mounts themselves.

Note: Whenever possible, the engine and gearbox should be installed whilst the hull is afloat, otherwise there is a danger of the hull distorting because of insufficient support over its surface. If the engine and transmission are fitted before the hull is in water, the installation should be very carefully re-checked for alignment after launching.

In designing PRM80, SAE standards were adhered to as far as possible. However, other manufacturers of similar sized transmissions have a different, but common, output coupling spigot, which is not to SAE. This spigot size has become the industry standard and most proprietary flexible output couplings are made to suit.

5.6 Installation angle

The transmissions should normally be installed so that the maximum fore and aft angle relative to the water line does not exceed 15° with the boat at rest. Please consult Newage Transmissions Ltd. if installation angles greater than this are required.

5.7 Remote control operating systems

The engine must be at idle before changing direction, therefore the PRM80 should be used with remote control operating systems which must be of the single lever type of remote control, i.e. Morse MT3 or SL3 which controls both the engine throttle and gear selection.

The following points should be noted:

- i) The gearbox operating lever is provided with a positive neutral position, which greatly assists the setting up of the remote control unit.



CAUTION ii) care should be taken to ensure that the cable moves the gearbox lever to the full extent of its travel both forward and backward. This is most important for correct gear selection.

The control equipment should in all cases be connected in accordance with the manufacturer's recommendations.

6. OPERATION

6.1 First time usage



CAUTION: Before starting the engine fill the gearbox to the correct level with a suitable oil (refer to recommended list, section 4.3 Page 7).

Ensure the gearbox is in neutral. Start and run the engine for a short time so that the oil circulates through the gearbox. Stop the engine and allow the oil to settle for 2 minutes, re-check the level and top up if required to the maximum mark on the dipstick. The minimum oil level is the bottom of the dipstick.

Note: The dipstick should be screwed down when checking the oil level.

6.2 Drive selection

The PRM80 has been designed to operate with proprietary single lever control systems which decreases the engine speed to idle before opposite gear selection can be made. It is most important that when changing direction a short pause is taken in neutral at engine idle before selecting gear. (see section 5.7)

6.3 Trailing (free wheeling) the propeller

The output shaft can be rotated continually with the engine shut down which makes the PRM80 particularly suited for use in auxiliary sailboats, sailing yachts etc. It can also be locked, but in opposite gear to forward direction.

7. ROUTINE MAINTENANCE

7.1. Initial maintenance (after 25 hours running)

Drain all oil from the gearbox, the drain plug is located in the centre of the underside of the transmission, a 25.4mm (1.0") across flats spanner is required. Refit drain plug.

Refill with oil as stated in 4.3. Page 7.

7.2 Daily checks

Check the gearbox oil level.

Visually inspect for oil leaks and general condition of the gearbox.

7.3 Six monthly check

Check the remote control operating linkage is accurately adjusted to give maximum travel (stop to stop) in both directions.

7.4 Annual check

All above checks.

Propeller shaft alignment inspection.

Change gearbox oil and re-fill.

8. FAULT FINDING

The following fault finding chart is designed to help diagnose some of the problems which might be encountered. It assumes that the installation and operating instructions in this manual have been followed and we advise that these are checked before proceeding to fault finding.

To avoid prejudicing warranty rights, no repair or other work should be done on the gearbox during the warranty without first contacting Newage Transmissions Ltd. or an authorised distributor or dealer for advice.

FAULT FINDING CHART

SYMPTOM	CAUSE	REASON	REMEDY
No drive ahead or astern		Broken drive plate Broken input shaft Broken output shaft	Replace drive plate Replace input shaft Replace output shaft
Propeller speed does not increase with engine speed, ahead and astern		Remote control cable or linkage not allowing F-N-R lever to move correct distance	Remove cable and operate lever by hand to check movement. Adjust cable if necessary
Propeller speed does not increase with engine speed in one direction only		Damaged clutch cones Incorrect lever setting	Remove and examine clutch cone and replace if necessary Reset lever to end stops
Excessive noise from gearbox at low speeds	Engine idle speed set too low Torsional vibration	Faulty adjustment Torsional incompatibility of elements in driveline	Increase idling speed If not cured by increasing engine idling speed, refer to engine supplier
Excessive noise throughout operating range	Defective input coupling Propeller shaft misalignment	Input coupling worn or damaged Hull flexing or faulty installation	Remove, examine and replace if necessary Check the alignment of the propeller shaft coupling; if necessary rectify by adjusting the shims under the engine mounts or the engine mounts themselves
Excessive vibration throughout operating range	Propeller out of balance Engine/gearbox misalignment Defective bearing	Propeller damaged or badly machined Faulty installation Bearing worn or damaged	Remove the propeller and check that the pitch, weight, diameter and balance of all the blades are equal and rectify if necessary. Remove the transmission and check that the flywheel face is flat and that the flexible input coupling is aligned correctly Isolate defective bearing, remove and replace
Excessive oil temperature	Power too high Oil level too high/low	Incorrect engine rating Incorrect oil type	Re-assess engine power Fill with correct oil Fill to correct oil level on dipstick
Oil level needs constant topping up	Oil leaks	Defective oil seal, sealant or 'O' ring	Clean the outside of the gearcase, particularly around the ends of shafts including the output shaft. Run the engine and inspect the gearbox for leaks. Replace seals as required
Escape of high pressure from gearbox when dipstick is removed	Defective breather causing leaks past oils seals		Contact distributor or factory for advice
Difficulty in moving single lever control	Faulty installation	Incorrect selector shimming Remote control operating cable kinked or frayed	Re check shimming see 9.7.6 for procedure Check the installation and eliminate all tight bends in the cable



WARNING: Before carrying out any service work always ensure that the engine is switched off and disconnect the operating cable from the gearbox.



CAUTION: The above operations should be carried out by suitably qualified personnel and strictly in accordance with the procedures detailed in the workshop manual.

9. SERVICING AND REPAIRS - GENERAL



WARNING: Before removal of the gearbox for repair or overhaul carefully study the following procedures. Use proper hand tools, slings or hoists for the job - **WORK SAFELY**
Keep all work areas, tools and gearbox clean. Wipe up any spilled oil or fluids to prevent accidents. Wear correct safety equipment i.e. safety glasses and safety shoes to guard against personal injury.

Remember **WORK SAFELY - USE COMMON SENSE.**

Drawings showing all internal components are contained in the parts lists. See page 17.

9.1 Seals

Remove oil seals carefully to prevent damage if they are to be re-used, however it is best to replace these items.

9.2 Bearings

If removing bearings for re-use keep them in a clean area to prevent dirt contamination.

9.3 Cleaning



WARNING: If using cleaning solvents these can be toxic, flammable, a skin irritant or give off harmful fumes. Avoid prolonged contact, vapour inhalation, or smoking. Failure to take care can result in injury or death.

Rinse all metal parts in solvent to remove dirt, grease and oil.

Be careful to remove solvent from items before re-fitting.

9.4 Inspection

9.4.1 Gearcase

Inspect for cracks. Check sealing surfaces for any scratches, damage etc. which will lead to oil leaks.

9.4.2 Gears

Inspect for any chipped broken or cracked gear teeth, also for any excessive wear, i.e. gear pitting.

9.4.3 Bearings

Inspect for any damage, pitting or over-heating.

9.4.4 Threaded parts

Inspect for stripped or damaged threads.

9.5 Assembly



CAUTION: All threaded fasteners must be tightened to the torques listed in table 10.2, page 16 to prevent premature failure.

CAUTION: A new drive flange nut (1) must be fitted if this is removed. Prior to assembly oil all internal parts with clean gearbox oil.

9.6 Disassembly of gearbox

Drain oil and remove adaptor plate. Hold drive flange (2) securely whilst removing locknut (1), carefully remove the "staked" portion of locking device so as to avoid damaging thread of output shaft (4).

9.6.1 Selector assembly

Remove the drive flange (2). Release two nyloc nuts (37) securing selector housing (24). Withdraw selector assembly ensuring selector shoe (28) and spring (25) do not fall into the gearbox.

9.6.2 Gearcase assembly

Remove locknut (41) securing idler shaft (46) into gearcase. Remove eleven bolts (31) and using a soft mallet lightly tap on the end of the input shaft (12) to split the two casings apart from dowels (11A). Remove the front cover (19). Withdraw the idler shaft (46) the output shaft assembly (4) and the input shaft (12).

9.6.3 Input shaft

Removal of the bearings (14) may damage them, therefore it is good practice to replace these items if removed. (see 9.4.3)

9.6.4 Output shaft

Carefully remove "staked" portion of locking device so as to avoid damaging the thread and remove locknut (9) from output shaft (4). Using a bearing puller remove the bearing (14) on the output end of the output shaft.

Remove the following: thrust washer (3), gear (13), needle bearing (16) (carefully checking for wear), inner ring (18), thrust washer (3), cone clutch (5). Using puller remove the bearing (7) on the input end of the shaft, thrust washer (3), output reverse gear (6), needle bearing (16) (again carefully checking for wear), and thrust washer (3). Save shims (8) for rebuild.

Note: Removal of ball bearings may result in damage, therefore replacement will be necessary.

9.6.5 Idler shaft

Remove locknut (41) and supporting gear (44) on soft material i.e. wood or similar to prevent damage to gear, tap the shaft (46) through the gear and remove bearing (43). Check condition of 'O' ring (42).

9.6.6 Selector

By hand remove selector shoe (28) and the selector spring (25). Pass the selector control body (23) through the housing (24) and remove 'O' ring (36) and oil seal (38) if replacing them.

9.6.7 Front cover

If it is required to replace the front cover (19) then it will be necessary to remove the oil seal (10). If the bearings (14) and (7) are to be re-used then care must be taken not to damage them on removal.

Note: When re-fitting oil seal (10) set in 1.5mm from face as shown on page 18.

9.6.8 Gearcase

If it is required to replace the gearcase (15) then again if the bearings are to be re-used care must be taken in their removal. Remove output seal (17) two studs (35) dipstick/breather (33) drain plug (30) and two dowel pins (11a).

9.7 Re-assembly of gearbox

(Note: coat all bearings with clean gearbox oil prior to fitting).

9.7.1 Input shaft

Press the two bearings (14) onto the input shaft (12) taking care to position correctly as illustrated. Make sure waved washer (11) is correctly positioned into case before fitting shaft.

9.7.2 Output shaft (see 9.7.5 for shimming procedure)

All of the following components are fitted over the output spline end of the shaft (4).

Thrust washer (3) inner ring (18) needle bearing (16) output gear (13) with cone towards the scroll, thrust washer (3) and bearing (14) (Press on).

Fit the following components from the opposite end of the shaft (4).

The cone clutch (5) thrust washer (3) inner ring (18) needle bearing (16) output reverse gear (6) ensuring cones match, thrust washer (3) press on bearing (7) re-shim if components have been changed (see 9.7.5) fit locknut (9).



**CAUTION: Remember to tighten locknuts (9) to recommended torque.
(SEE TORQUE CHART 10.2, PAGE 16)**

9.7.3 Idler shaft

Press bearings(43) into idler gear (44) and fit internal circlip (45) into idler gear thereby retaining the bearings. Press idler shaft (46) through the bearings as far as the shoulder. Fit 'O' ring (42) to shaft groove and coat with clean gearbox oil to assist fitting into the case. Fit locknut (41) and tighten to recommended torque (see torque chart 10.2 page 16).

9.7.4 Selector housing assembly

* Before proceeding with this assembly see shimming procedure 9.7.6 page 16.

Press in oil seal (38) flush to the face of selector housing (24). Using tool number PR29418 insert into seal to expand it whilst assembling selector control body (23) into the selector housing (24). This will displace the tool and allow the control body to slide through the seal. Fit the 'O' ring (36) to selector housing, insert spring (25) and selector shoe (28) into selector housing.

9.7.5 Shimming (bearings)

The output shaft bearings must be shimmed zero to 0.025mm preload.
This is achieved as follows:

- | | |
|---|---------------|
| 1. Measure shaft over the bearings. | Dimension A |
| 2. Measure case bore depth to joint face | Dimension C |
| 3. Measure cover bore depth to joint face | Dimension B |
| 4. Add cover and case bore depths to give "bore face lengths". | Dimension Y |
| 5. Subtract bore face lengths from shaft lengths to achieve shim requirement. | Dimension Y-A |
| 6. Fit shims as required to within zero to 0.05mm preload. | |

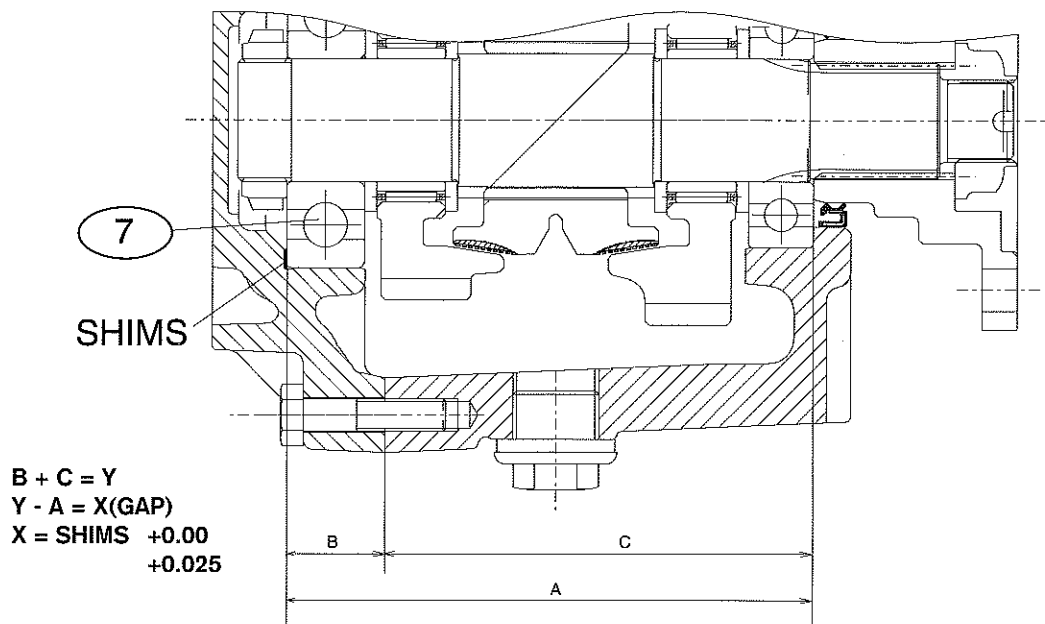

Fig. 4

Place the shims (8) into the appropriate bore of the front cover (19) so that they are located under the bearing (7).

Locate both input and idler shaft assemblies into the bearings. Fit the two dowels (11A) and apply silicon sealant to the joint face.

Assemble the front cover (19) ensuring dowels are correctly located and fit 11 bolts (31) tightening to the recommended torque.

Fit locknut (41) to the idler shaft, tighten to the recommended torque and then fit the two studs (35) to the gearcase using a hydraulic sealant. (see torque chart 10.2 page 16)

Move the cone clutch (5) to the neutral position, and locate the assembled selector mechanism over the two studs (35). Locate the selector shoe (28) into the groove of the cone clutch, ensuring the identification pip of the selector shoe is uppermost.

Fit the two nuts (37) to the studs (35), tighten to the recommended torque. Secure gear selector lever (22) to the selector control body (23) using bolt (39) washer (40) and nyloc nut (37). Fit oil seal (17) to gearcase bore and oil seal (10) to the front cover (19) (see tool sheet). Assemble the output coupling (2) to the output shaft.

Apply silicone sealant to the flat face of the locknut (1) and hydraulic sealant to threads of the shaft. Fit locknut (1).



CAUTION: Remember to tighten locknut (9) to the recommended torque and stake the nut into slot. When using sealants and locking compounds all surfaces should first be cleaned by degreasing.

Fit magnetic drain plug (30) to underside of the gearcase. Fit dipstick breather (33) and sealing washer (32). Finally adjust the gear selector lever (22) into the required position.

9.7.6 Selector mechanism shimming

Assemble the bolt (21) into the selector mechanism leaving a gap of approximately 2mm.

Ensure the selector mechanism is positively located in the neutral position.

By hand, hold in the mechanism whilst rotating the output coupling in a clockwise direction as viewed from the output coupling. This rotating action will force out the mechanism to the top dead centre. Re-affirm that the selector is still located in the positive neutral.

Carefully screw in the bolt (21) until contact is made with the end of the shoe, thus removing all end float (see caution below) using feeler gauges measure the gap under the head of the bolt.

Add to the measured dimension 0.6mm (+ 0.1mm - zero tolerance).

Remove the bolt (21). Place the measured shims under bolt head. Apply hydraulic sealant to the bolt threads re-fit and tighten to the recommended torque.



CAUTION: This condition can only be maintained with the clutch at the top dead centre. If this is not achieved the gear selection will be affected, creating difficulty in gear engagement or disengagement.

10. SPECIAL TOOLS

Oil seal to selector housing	PR29418
Oil seal to gearcase	PR29281
Oil seal to front cover	PR29283
Spanner for locknut CP1413	PR30154

10.1 Tool Kit

Socket size	13mm
	24mm
	30mm
Drain plug	1" A/F
Dipstick	1/2" A/F

10.2 Tightening torques

RECOMMENDED TIGHTENING TORQUES			
Size	Grade	Type	Nm
M8	8.8	Nut	24
M8	8.8	Stud	13
M8	8.8	Screw	30
M16	8.8	Binx Nut	56
M20	8.8	Special nut	205
M30	-	Locknut	150

11. REPLACEMENT PARTS ORDERING

When ordering replacement parts the following should be quoted:

- Gearbox model and serial number
- Description(s) and part number(s) of the component(s) required
- Quantity required
- Orders and enquiries for replacement parts must be made through Newage distributor/dealer network

NOTE: Enquiries relating to a technical or service nature can be made direct to:

PRM MARINE LIMITED
BARLOW ROAD
COVENTRY CV2 2LD
ENGLAND

TEL: +44 (0)24 7661 7141
FAX: +44 (0)24 7661 1845

PARTS LIST

ITEM NO.	DESCRIPTION	PART NO.	QTY
1	Locknut M20x1.5	MT8095	1
2	Drive Flange	MT8099	1
3	Thrust washer	0593003	4
4	Output shaft	MT8206	1
5	Cone clutch	MT8098	1
6	Output reverse gear 2.5:1 ratio	MT8398	1
7	Bearing	CM2068	1
8*	Shim 0.05, Shim 0.25, Shim 0.075 mm	MT1077/02/10/31	As required
9	Locknut M30 x 1.5	CP1413	1
10***	Oil seal	0400286	1
11	Waved Washer	0191248	1
11a	Dowel	0210815	2
12	Input shaft 2:1 ratio	MT8403	1
	Input shaft 2.5:1 ratio	MT8401	1
13	Output forward gear 2:1 ratio	MT8402	1
	Output forward gear 2.5:1 ratio	MT8399	1
14	Bearing	40M149	3
15	Gearcase	MT8198	1
16	Needle Bearing	0563502	2
17***	Oil seal	0400407	1
18	Inner ring	0583001	2

* Contained in shimming kit MT0068

*** Contained in Oil Seal 'O' Ring Kit MT0428

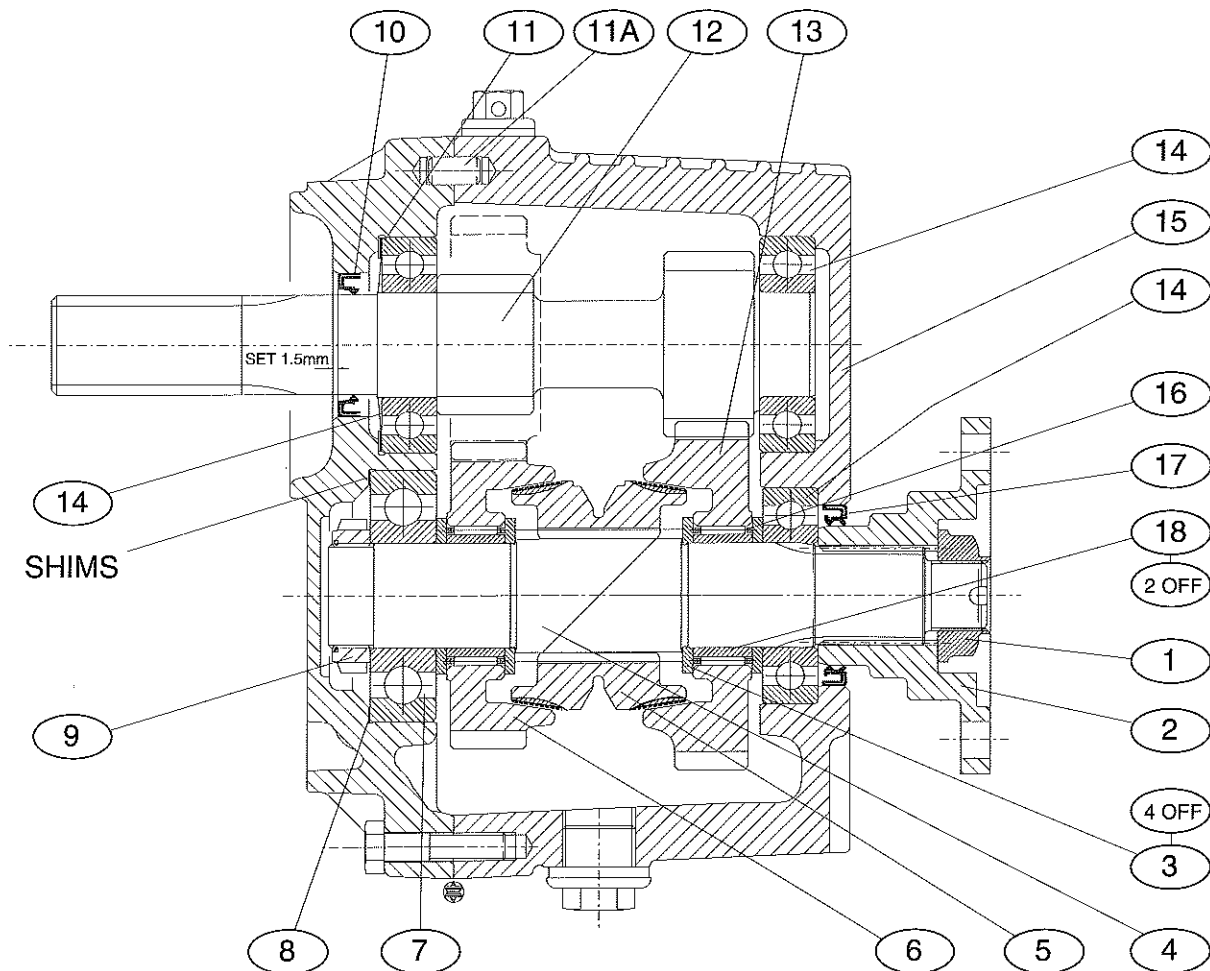

ITEM NO.	DESCRIPTION	PART NO.	QTY
19	Front cover	MT8197	1
20	Washer M8	0191007ZP	1
20A**	Shim 0.125, Shim 0.25, Shim 0.50mm	057017B/C/D	As required
21	Bolt M8 x 26	MT8117	1
22	Gear selector lever	MT8100	1
23	Selector control body	MT8102	1
24	Selector Housing	MT8101	1
25	Spring	0311042	1
26	Spring dowel	010-0210	1
27	Selector pin	MT8104	1
28	Selector shoe	MT8103	1
29	Bonded seal 1/2" BSP	0201714	1
30	Magnetic drain plug	CP1331	1
31	Bolt M8 x 35	0040810ZP	11
32	Bonded seal	CP1204	1
33	Dipstick/Breather	MT8255S/A	1

** Selector shim kit containing 3 off each shim MT0430

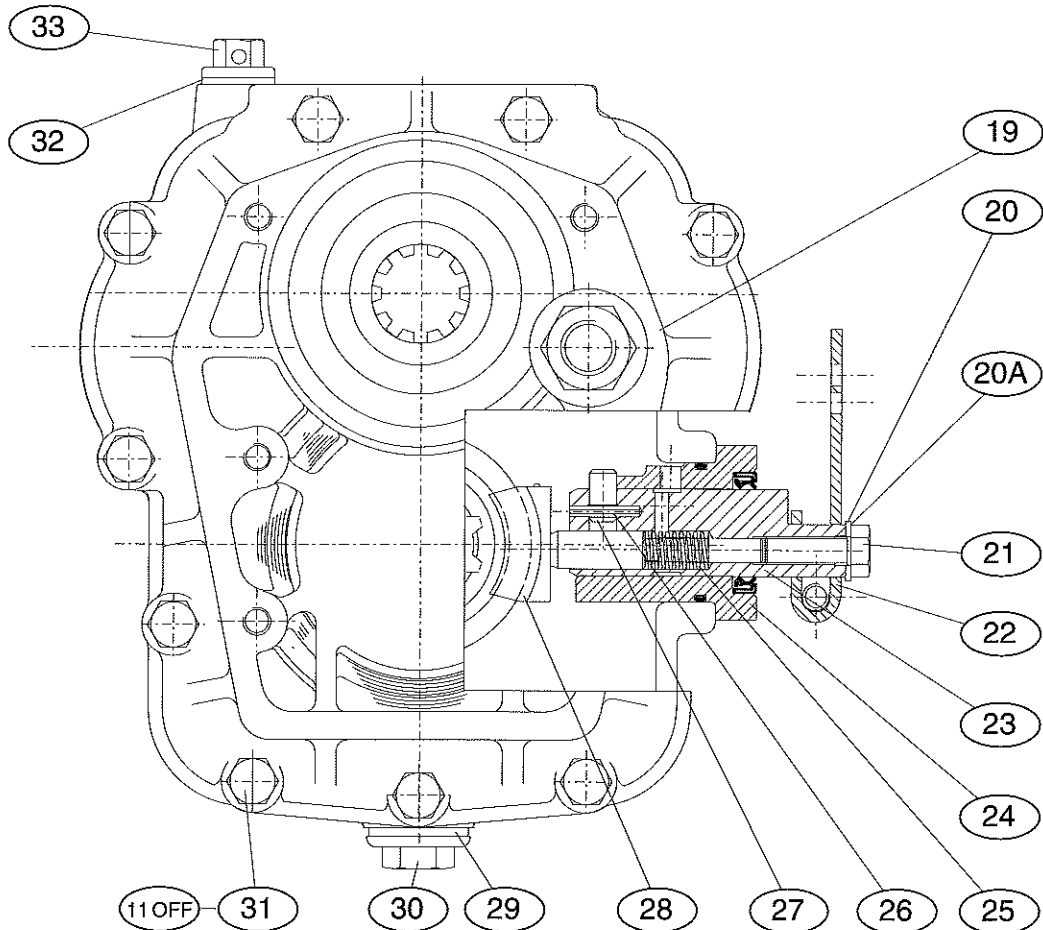

ITEM NO.	DESCRIPTION	PART NO.	QTY
35	Stud M8 x 37	MT3094	2
36***	'O' ring	04303524	1
37	Nut nyloc M8	0050806ZP	3
38***	Oil seal	0400255	1
39	Bolt M8 x 35	0040810ZP	1
40	Plain washer	0191007ZP	1
41	Binx nut M16	0051610	1
42***	'O' ring	04301416	1
43	Bearing	0511710	2
44	Idler gear	MT8400	1
45	Internal circlip	0250350	1
46	Idler shaft	MT8201	1

*** Contained in 'O' ring/oil seal kit MT0428

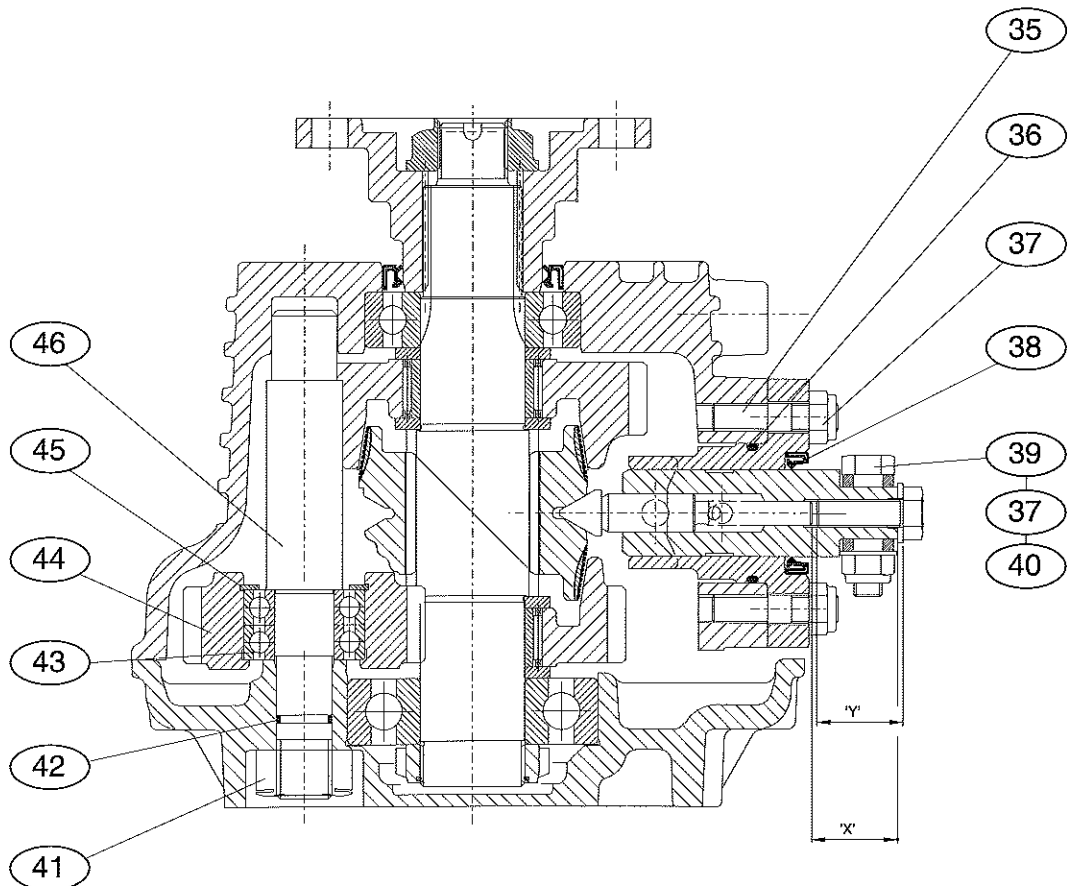





FROM

**NEWAGE
TRANSMISSIONS LIMITED**

Barlow Road, Coventry CV2 2LD England

Telephone: +44 (0)24 7661 7141

Fax: +44 (0)24 7661 1845

Email: mail@newage-prm.co.uk

Website: <http://www.newage-prm.co.uk>



Certificate No. Q10728.

© Newage Transmissions Limited.
Newage Transmissions Ltd. is a member of BI Group Plc.
Registered in England - No 345283
Registered Office - Neville House, 42-46 Hagley Road,
Birmingham B16 8PZ
Printed in England by Beechwood Litho (024) 7671 3792